

Breedon Aggregates

Breedon Aggregates from their West quarries offer the supply of aggregate, ready mix concrete and asphalt products along with a surfacing and civil engineering service to suit all your needs.

The aggregate, ready mix concrete and asphalt products can be delivered in our fleet of Lorries or collected from our quarry. Breedon Aggregates offer their services to large civil engineering and construction contractors, building contractors, self-build and cash customers.

Breedon Aggregates have quarries in the following locations –

Banavie

Located in Fort William has an asphalt and concrete plant which has a pan mixer from which customers can uplift concrete, the quarry supplies a full range of fill materials and decorative aggregate.

Benderloch

Located on the outskirts of Benderloch village, Breedon has a concrete plant with a pan mixer from which customers can uplift concrete, the quarry supplies a full range of sand and gravel and fill materials.

Bonawe

Located beside the village of Bonawe on the banks of Loch Etive the quarry has an asphalt plant

and supplies a full range of fill materials and decorative aggregate. The quarry has access to ship material via its pier to Islands or mainland ports.

Furnace

Located between Inveraray and Lochgilphead on the banks of Loch Fyne has an asphalt and concrete plant and supplies a full range of fill materials and decorative aggregate. The quarry has access to ship materials via its pier to Islands or mainland ports.

EZ Street Cold Asphalt

Breedon Aggregate hold stocks of EZ Street Cold Asphalt at Benderloch Quarry in 1 tonne bulk bags and 22kg bags. This is a permanent repair for potholes, utility Cuts, repairs and surfacing patches which is similar in appearance and performance to a good hot asphalt mix and can be laid in any weather conditions. More information is available from our Dunbeg sales office - please call 01631 565128 for more info and visit www.breedonaggregates.com

Kit Homes

Kit homes have seen a rise in popularity in recent years due to their stylish designs, energy-efficiency and affordability. In addition, kit homes allow homeowners to take part in their property's construction, which can be a satisfying experience for many.

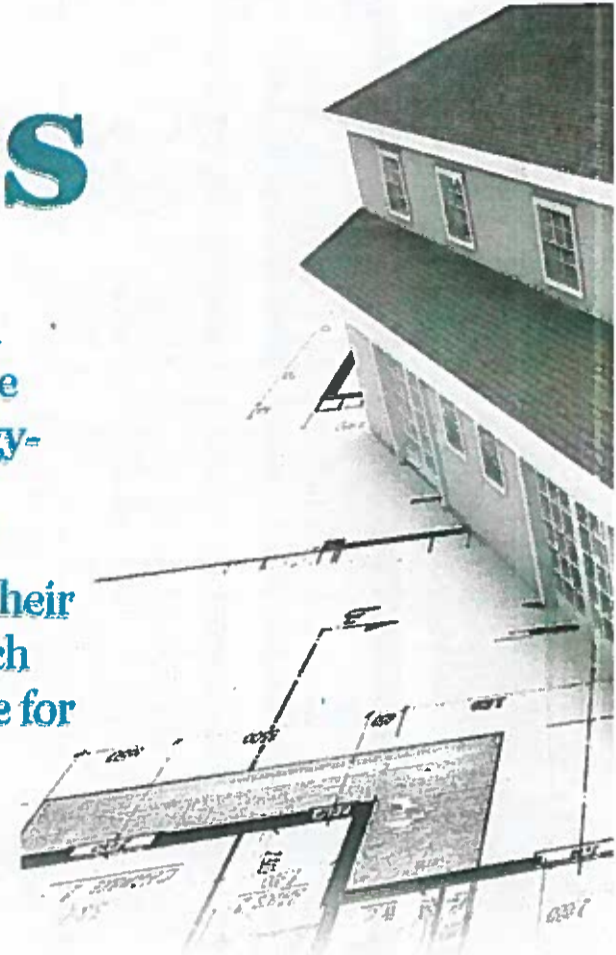

Kit homes have seen a rise in popularity in recent years due to their stylish designs, energy-efficiency and affordability. In addition, kit homes allow homeowners to take part in their property's construction, which can be a satisfying experience for many. A kit home is designed and partially manufactured off site and then all the materials are delivered by truck to the construction site for assembly. Some kits have parts that will need to be cut and trimmed on site. Kit homes are spacious and functional, as well as self-sufficient and sustainable. They have an open-plan layout, pre-built components that allow better quality control, eco-friendly properties and design flexibility.

Affordability

Kit homes are more affordable than conventional homes. Their costs will vary depending on the type of home you choose, what is and isn't included in the package, how much of the work you'll take on yourself, and if you're hiring a contractor to build the home. Generally, a kit home package will cost about one third of the total cost of the completed home. Most kits only come with the materials

for the home's exterior shell. The cost of labour, land, utilities and completing the interior are generally not included in the kit price. But overall, kit homes are still cheaper, costing 40% less to build. Applying what you've learnt from your research and an owner-builder course can also save time and money. You can save more money by doing more of the work yourself. However, if you have no training in construction, hire a building contractor. This means the home can be assembled onsite much faster.

Ease and eco-friendly features

Building a kit home is easier and less wasteful, as the manufacturer has already worked out the basic plans and technical details, as well as cut and pre-assembled the materials. Green materials used include sea containers, timber, glass and steel. Thermal efficiency is also assured through energy-efficient heating systems, solar panels and insulation. You can also install water recycling features such as low-water shower, dual-flush toilets, grey water recycling and rainwater harvesting.

Reduce build time

It can take from several hours

to a few days to erect the exterior shell and install the roof, windows and doors with the aid of a small group of experienced carpenters. A contractor will then finish the interior, which could take 2-3 months. It will take longer (around 5-9 months) for owner-builders, particularly if you're living in the home while it's being built.

Customisable

Kit homes can be customised by the homeowner, at little to no cost. You can design rooms in any style and size you want.

Types of kit homes

Most kit homes fall into one of four main categories:

Log homes

Log homes are made of handcrafted logs or factory-milled logs that can expand and contract due to changes in humidity and temperature, so it's important to seal the logs properly together. Log homes can also shrink after being built, so keep this in mind and plan ahead. Log kits include interior fixtures.

Timber-frame homes

Also known as post-and-beam homes, timber-frame homes have no interior structural walls, so they offer flexibility

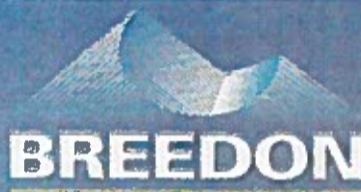

BREEDON
AGGREGATES

Suppliers of

Aggregates, Rock Products, Asphalt, Ready Mixed Concrete and Contracting Services.

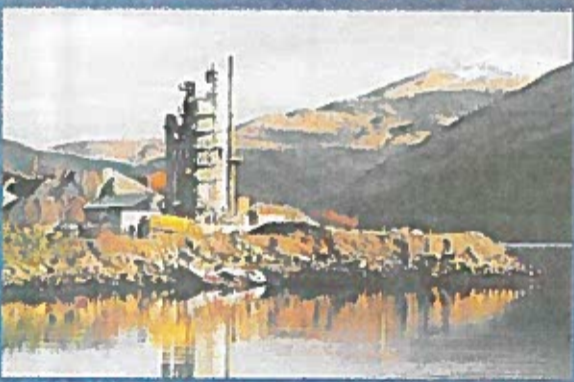

We also supply a wide range of decorative aggregates – ideal for gardens, drives and patios.

For friendly, professional advice, call our sales team now
enquiries@breedonaggregates.com

01631 565 128